

DANIELS FOOD EQUIPMENT

DVTS 100-TUMBLER

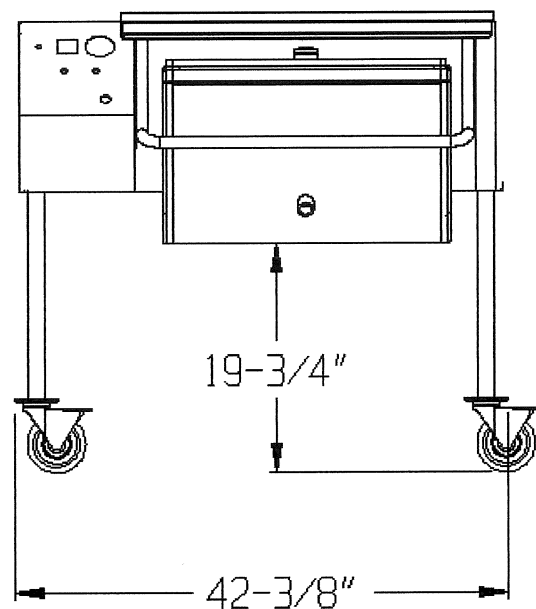
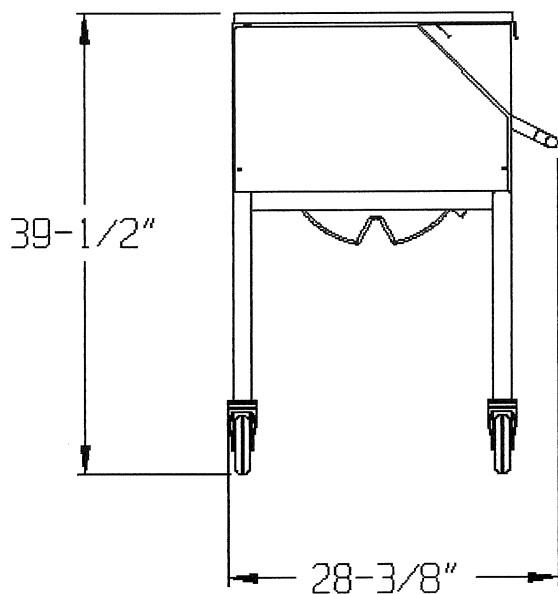

SPECIFICATIONS

TOTAL POWER INPUT:	15 AMP, 115 VOLT, 60 Hz 1-PHASE, 4 AMP TOTAL
TUMBLER DRIVE MOTOR:	120:1 RATIO, 1/8 HP, 130 VOLTS DC
VACUUM PUMP:	115 VOLT 3.6 AMPS, 60 Hz, 1-PH
TIMER:	DIGITAL-HOURS AND MINUTES
ELECTRONIC CONTROLS:	TUMBLER SPEED-ADJUSTABLE 0-16 RPM, TIMER "START"- "STOP", VACUUM PUMP "STOP"- "START" TOGGLE SWITCH
MAXIMUM CAPACITY:	100-LBS.
WEIGHT:	182-LBS. (NET)
OPTIONAL POWER INPUT:	220 VOLT, 60Hz, 1 PHASE, 2 AMP 220 VOLT, 50Hz, 1 PHASE, 2 AMP
OVER-ALL DIMENSIONS:	42-1/2" LONG X 25-3/8" WIDE X 39-11/16" TALL

DANIELS FOOD EQUIPMENT

310 NORTH CLAYBORN AVE. PARKERS PRAIRIE, MN. 56361 PHONE: (218) 338-5000 FAX (218) 338-5909.

WEB: www.danielsfood.com

E-MAIL: edaniels@danielsfood.com